

DIMENSIONS AND ELEVATIONS IN METERS

MAGNETIC VARIATION 8° W (2015)
 NO OBSTRUCTION

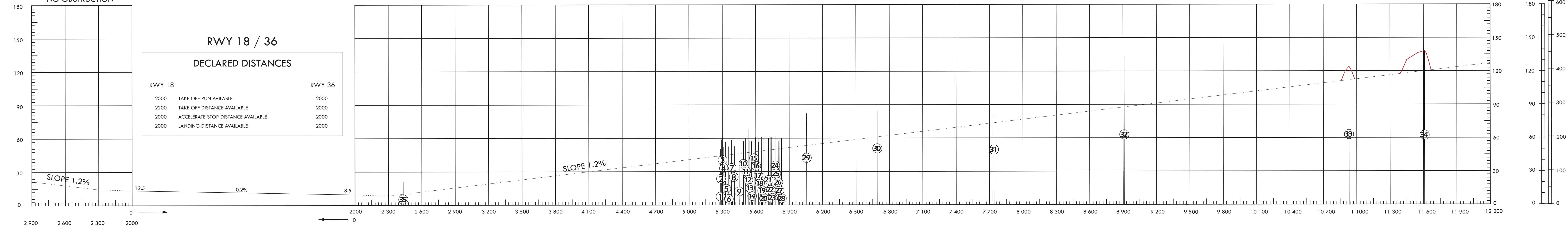

VERTICAL SCALE 1:1500

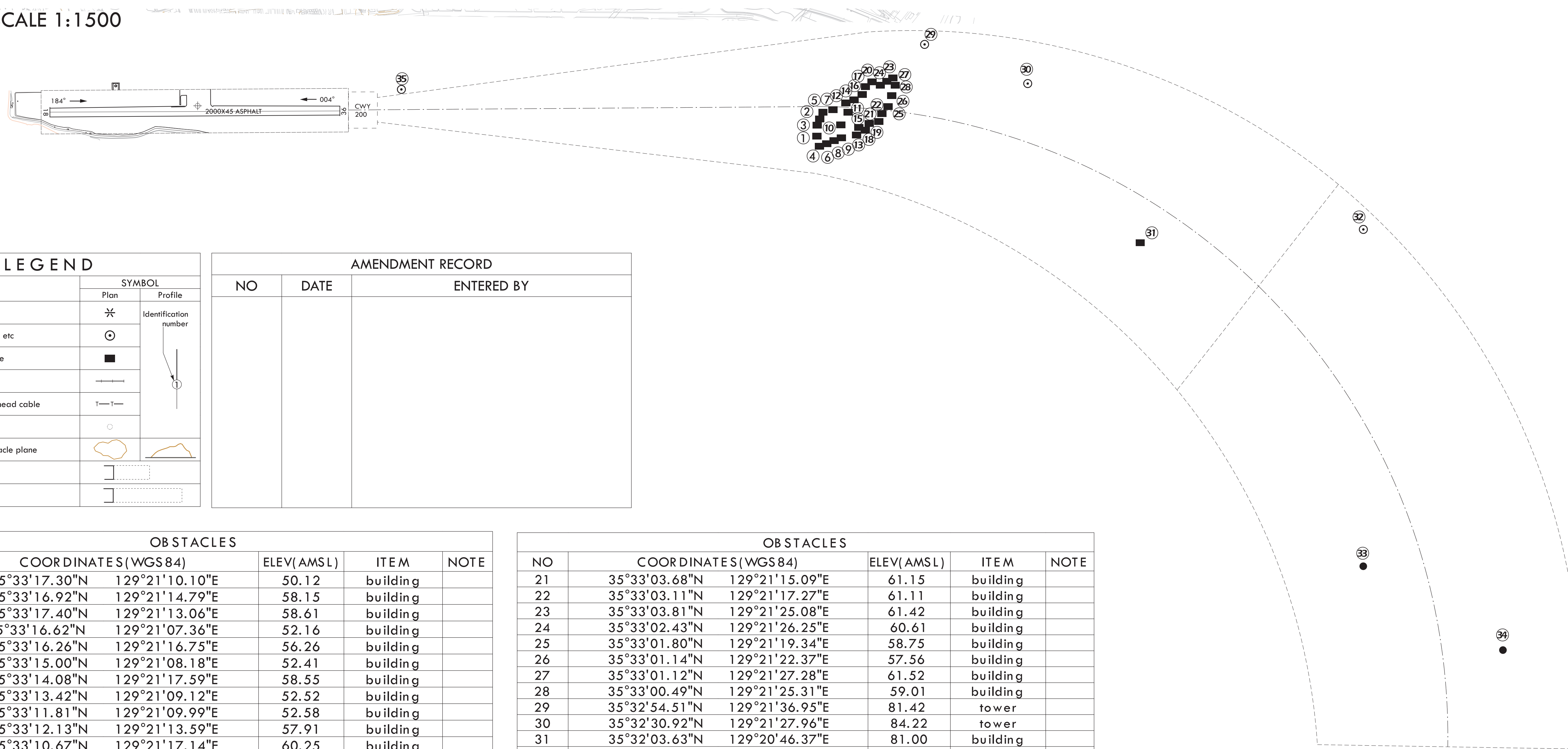

LEGEND	
ITEM	SYMBOL
	Plan Profile
Tree or shrub	✳
Pole tower spire antenna etc	⊙
Building or large structure	■
Railroad	—+—+—+—
Transmission line or overhead cable	—T—T—
Peak or Mountain	○
Terrain penetrating obstacle plane	⬭
Stopway(SWY)	⬭
Clearway(CWY)	⬭

AMENDMENT RECORD		
NO	DATE	ENTERED BY

OBSTACLES					
NO	COORDINATES (WGS 84)		ELEV (AMSL)	ITEM	NOTE
1	35°33'17.30"N	129°21'10.10"E	50.12	building	
2	35°33'16.92"N	129°21'14.79"E	58.15	building	
3	35°33'17.40"N	129°21'13.06"E	58.61	building	
4	35°33'16.62"N	129°21'07.36"E	52.16	building	
5	35°33'16.26"N	129°21'16.75"E	56.26	building	
6	35°33'15.00"N	129°21'08.18"E	52.41	building	
7	35°33'14.08"N	129°21'17.59"E	58.55	building	
8	35°33'13.42"N	129°21'09.12"E	52.52	building	
9	35°33'11.81"N	129°21'09.99"E	52.58	building	
10	35°33'12.13"N	129°21'13.59"E	57.91	building	
11	35°33'10.67"N	129°21'17.14"E	60.25	building	
12	35°33'11.28"N	129°21'19.63"E	57.75	building	
13	35°33'08.47"N	129°21'11.07"E	57.38	building	
14	35°33'09.51"N	129°21'20.62"E	57.82	building	
15	35°33'08.06"N	129°21'13.20"E	61.45	building	
16	35°33'07.72"N	129°21'22.23"E	60.62	building	
17	35°33'07.12"N	129°21'24.46"E	60.65	building	
18	35°33'06.55"N	129°21'12.54"E	56.71	building	
19	35°33'05.76"N	129°21'14.42"E	61.02	building	
20	35°33'05.70"N	129°21'25.85"E	61.34	building	

OBSTACLES					
NO	COORDINATES (WGS 84)		ELEV (AMSL)	ITEM	NOTE
21	35°33'03.68"N	129°21'15.09"E	61.15	building	
22	35°33'03.11"N	129°21'17.27"E	61.11	building	
23	35°33'03.81"N	129°21'25.08"E	61.42	building	
24	35°33'02.43"N	129°21'26.25"E	60.61	building	
25	35°33'01.80"N	129°21'19.34"E	58.75	building	
26	35°33'01.14"N	129°21'22.37"E	57.56	building	
27	35°33'01.12"N	129°21'27.28"E	61.52	building	
28	35°33'00.49"N	129°21'25.31"E	59.01	building	
29	35°32'54.51"N	129°21'36.95"E	81.42	tower	
30	35°32'30.92"N	129°21'27.96"E	84.22	tower	
31	35°32'03.63"N	129°20'46.37"E	81.00	building	
32	35°31'13.94"N	129°20'53.71"E	133.47	tower	
33	35°31'09.38"N	129°19'21.64"E	124.00	mountain	
34	35°30'37.03"N	129°19'01.06"E	138.00	mountain	
35	35°34'50.73"N	129°21'15.88"E	17.241	tower	

ORDER OF ACCURACY

HORIZONTAL 5.0 m
 VERTICAL 0.5 m

HORIZONTAL SCALE 1 : 15000

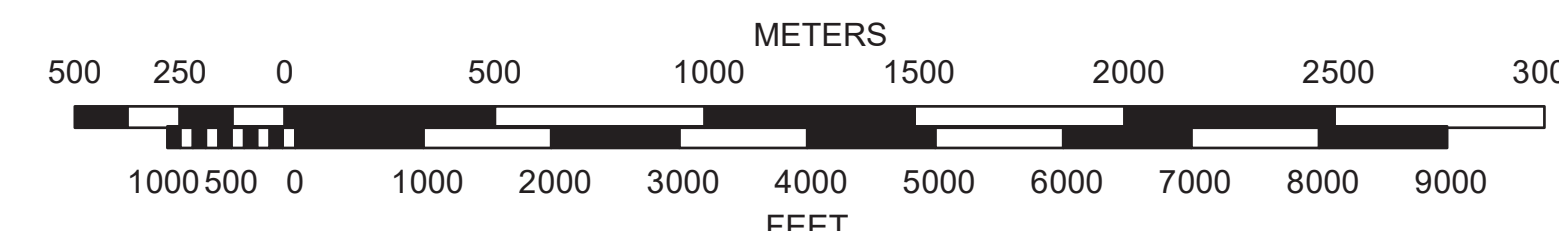

MAGNETIC VARIATION 8° W (2015)

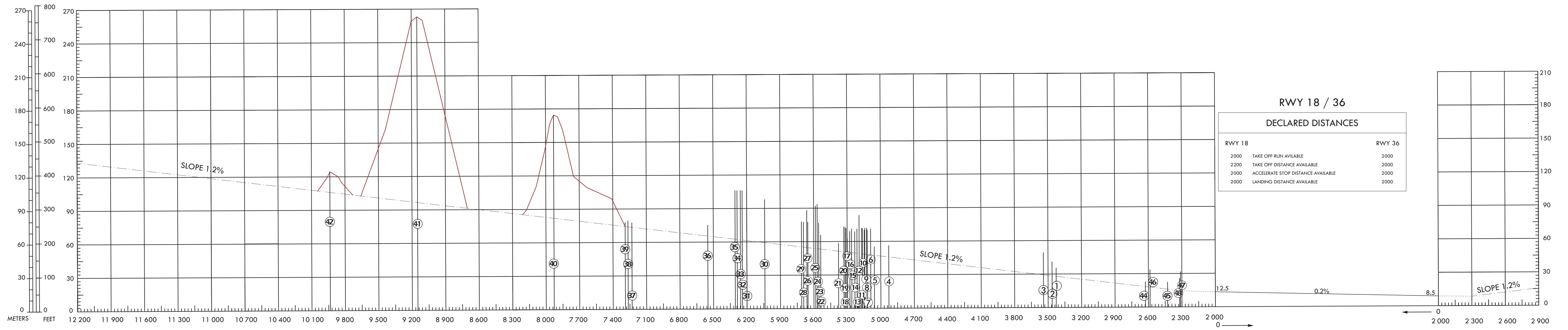

VERTICAL SCALE 1 : 1500

NO	DATE	ENTERED BY

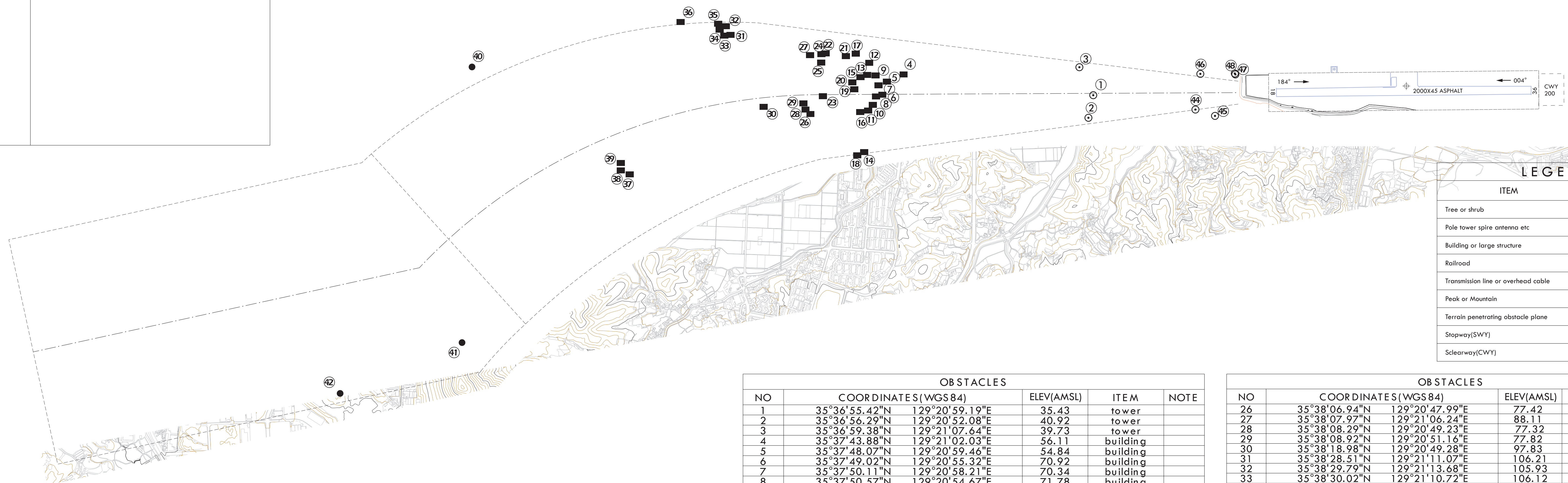

LEGEND

ITEM	SYMBOL	
	Plan	Profile
Tree or shrub	✳	Identification number
Pole tower spire antenna etc	⊙	
Building or large structure	■	
Railroad	—+—	
Transmission line or overhead cable	—T—	
Peak or Mountain	○	
Terrain penetrating obstacle plane	○	
Stopway(SWY)	□	
Clearway(CWY)	□	

OBSTACLES					
NO	COORDINATES (WGS84)		ELEV(AMSL)	ITEM	NOTE
1	35°36'55.42"N	129°20'59.19"E	35.43	tower	
2	35°36'56.29"N	129°20'52.08"E	40.92	tower	
3	35°36'59.38"N	129°21'07.64"E	39.73	tower	
4	35°37'43.88"N	129°21'02.03"E	56.11	building	
5	35°37'48.07"N	129°20'59.46"E	54.84	building	
6	35°37'49.02"N	129°20'55.32"E	70.92	building	
7	35°37'50.11"N	129°20'58.21"E	70.34	building	
8	35°37'50.57"N	129°20'54.67"E	71.78	building	
9	35°37'51.01"N	129°21'01.17"E	70.04	building	
10	35°37'51.22"N	129°20'52.02"E	71.62	building	
11	35°37'52.38"N	129°20'50.16"E	71.67	building	
12	35°37'52.83"N	129°21'04.98"E	53.62	building	
13	35°37'53.14"N	129°21'01.24"E	71.23	building	
14	35°37'52.73"N	129°20'37.14"E	68.83	building	
15	35°37'54.84"N	129°21'00.37"E	71.27	building	
16	35°37'54.34"N	129°20'49.53"E	62.44	building	
17	35°37'56.39"N	129°21'07.56"E	63.00	building	
18	35°37'54.42"N	129°20'36.03"E	68.91	building	
19	35°37'56.19"N	129°20'56.53"E	71.79	building	
20	35°37'56.83"N	129°20'58.58"E	71.90	building	
21	35°37'58.87"N	129°21'06.65"E	58.31	building	
22	35°38'04.03"N	129°21'07.09"E	65.81	building	
23	35°38'04.04"N	129°20'53.75"E	76.73	building	
24	35°38'05.07"N	129°21'06.81"E	93.42	building	
25	35°38'05.03"N	129°21'04.18"E	91.91	building	

OBSTACLES					
NO	COORDINATES (WGS84)		ELEV(AMSL)	ITEM	NOTE
26	35°38'06.94"N	129°20'47.99"E	77.42	building	
27	35°38'07.97"N	129°21'06.24"E	88.11	building	
28	35°38'08.29"N	129°20'49.23"E	77.32	building	
29	35°38'08.92"N	129°20'51.16"E	77.82	building	
30	35°38'18.98"N	129°20'49.28"E	97.83	building	
31	35°38'28.51"N	129°21'11.07"E	106.21	building	
32	35°38'29.79"N	129°21'13.68"E	105.93	building	
33	35°38'30.02"N	129°21'10.72"E	106.12	building	
34	35°38'31.34"N	129°21'12.48"E	106.01	building	
35	35°38'31.82"N	129°21'14.24"E	106.13	building	
36	35°38'41.98"N	129°21'14.07"E	104.92	building	
37	35°38'51.96"N	129°20'25.76"E	77.51	building	
38	35°38'54.23"N	129°20'26.81"E	79.41	building	
39	35°38'54.39"N	129°20'29.12"E	77.92	building	
40	35°39'33.67"N	129°20'56.15"E	174.51	mountain	
41	35°39'31.91"N	129°19'30.27"E	263.01	mountain	
42	35°40'02.09"N	129°19'12.16"E	124.51	mountain	
43	35°43'12.92"N	129°21'34.49"E	349.03	tower	No display
44	35°36'29.24"N	129°20'56.67"E	29.03	tower	
45	35°36'24.17"N	129°20'55.07"E	28.30	tower	
46	35°36'28.53"N	129°21'07.86"E	28.27	tower	
47	35°36'19.62"N	129°21'08.34"E	23.568	tower	
48	35°36'19.79"N	129°21'08.64"E	21.715	tower	

HORIZONTAL SCALE 1 : 15000

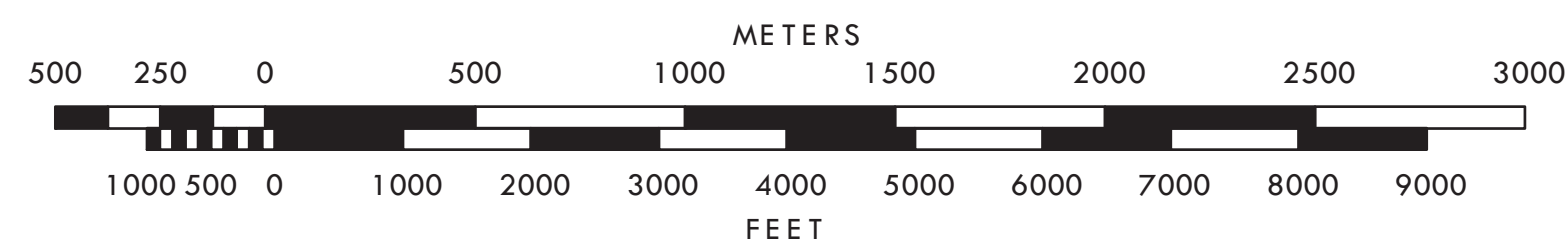

ORDER OF ACCURACY

HORIZONTAL 5.0 m
VERTICAL 0.5 m